

CERTIFICATE OF LOCATION OF GOVERNMENT CORNER

SOUTH QUARTER Corner of Section 32, Township 109, Range 16, 5TH P.M.

STATE OF MINNESOTA, County of GOODHUE.

At the corner location shown on the sketch

- ☒ ON 11/14/2000 found A 2.5 INCH CIRCULAR AREA OF BLACK DIRT DEPOSIT IN
NATURAL CLAY. THE DEPOSIT WENT DOWN ANOTHER 8 INCHES AND CAME TO A POINT.
☒ left monument as found, ☐ lowered monument, ☐ removed monument (explain)
- ☒ ON 11/14/2000 placed a 1.5 INCH X 30 INCH IRON PIPE WITH
A GOODHUE COUNTY BRASS CAP.

SKETCH OF REFERENCE TIES

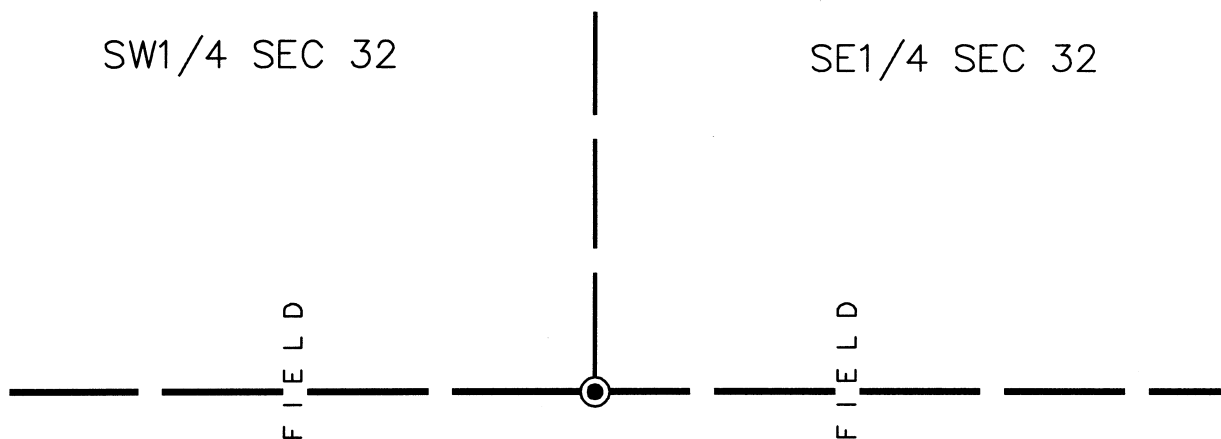

SECTION 5

Statement of evidence relative to this corner is on back of page

I hereby certify that this document and the data contained herein was prepared by me or under my direct supervision.

Dennis Robinson 3/17/04
SIGNATURE DATE

Registration No. 19096

- ☐ Land surveyor, ☐ Professional Engineer
☐ Deputy
☐ County Surveyor, ☐ County Engineer

OFFICE OF THE COUNTY RECORDER

County of GOODHUE.

I hereby certify that this document was filed in the Co. Recorders office at _____ .M. on the day of _____ A.D., 20

County Recorder _____

By _____, Deputy

DOCUMENT NO. _____